

# PALM COVE ONLY

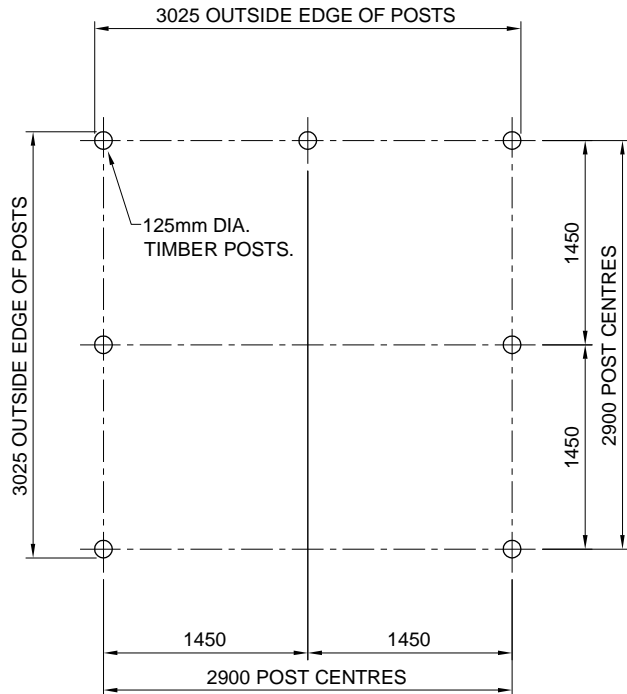

PLAN POST SETOUT

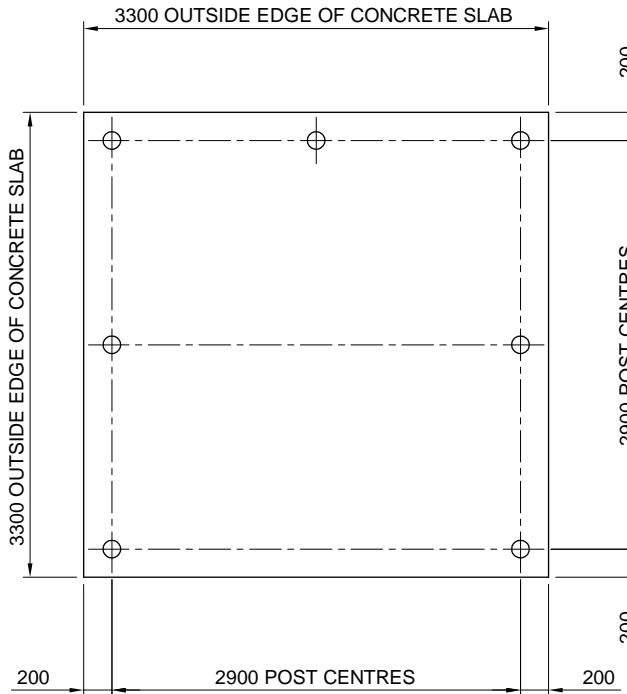

PLAN BASE SETOUT



PLAN BEACH HUT: PALM COVE IN POSITION ON BASE

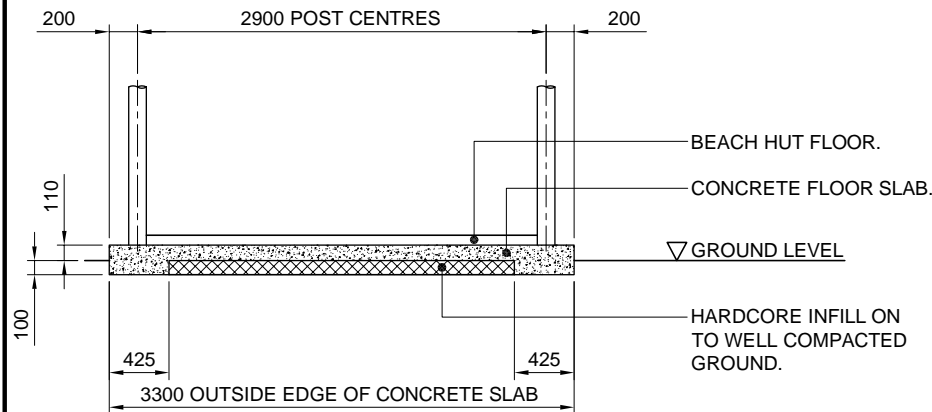

SECTION THRO' BASE

**NOTES:**

**CONCRETE SLAB:**  
 CONCRETE TYPE C20(20N/mm<sup>2</sup> STRENGTH) BASE TO BE LAID FLAT & LEVEL. CONCRETE SLAB TO BE LAID ON WELL COMPACTED GOOD GROUND, IF POOR GROUND IS ENCOUNTERED A WELL COMPACTED HARDCORE SUB-BASE MIN 100mm MAY BE REQUIRED.

**SETTING OUT:**  
 THIS INFORMATION IS GIVEN IN GOOD FAITH, ANY ERROR TO BE REPORTED TO BEACH HUT LEISURE IMMEDIATELY. DO NOT SCALE FROM THIS DRAWING. THE PREPARATION OF THE BASE IS THE CLIENTS RESPONSIBILITY. IF THE BASE IS NOT FLAT/LEVEL & INSTALLED TO THE CORRECT DIMENSIONS WE WILL NOT BE ABLE TO INSTALL THE BUILDING. COSTS WILL BE CHARGED TO THE CLIENT FOR VISITS TO SITE WHERE THE BUILDING CAN NOT BE INSTALLED BECAUSE OF INCORRECTLY BUILT BASES & WHERE A CLEAR SAFE ACCESS PATH TO INSTALL THE BUILDING HAS NOT BEEN PROVIDED. THE BUILDING WARRANTY WILL BE VOID & NULL IF THE BASE FAILS IE. SUBSIDENCE UNEVEN SETTLEMENT ETC.